

Notes:

- All nail fixings pre-drilled minimum 1mm diameter smaller than nail gauge
- All products to be pre-coated & cut edges to be sealed as per Branz Bulletin 411
- All materials and fixtures are to comply with E2/AS1 clause 2.2
- Provide PVC tape bond break between H3.2 battens and any flashing
- Rigid & Flexible underlay as per table 23 and clauses 9.1.5 to 9.1.7
- Timber to NZBC B2 durability B23.1 (b), Western Red Cedar, Larch

6mm Fibre cement Rigid Wall Underlay
As per table 23 and clauses 9.1.5 to
9.1.7 and 9.1.7.2 E2/AS1

Framing

CCA treated BBS 20x40-V
H3.2 timber cavity batten

75mm annular grooved
rose head, silicone bronze
or stainless steel nail

Rustic plugs to suit
weatherboard profile
fixed in bed of sealant

Seal between board with
continuous bead of
Construction sealant

90x19mm
Coverboard BBS202

69x19mm
Coverboard BBS201

80mm PBS butyl tape lapped
evenly to corner over 100mm
strip PBS Butyl primer

9x9mm compressible
foam strip

Minimum 50x50mm corner flashing
hem edge folds compatibility to comply
with NZBC E2/AS1

BBS Rusticated Weatherboard

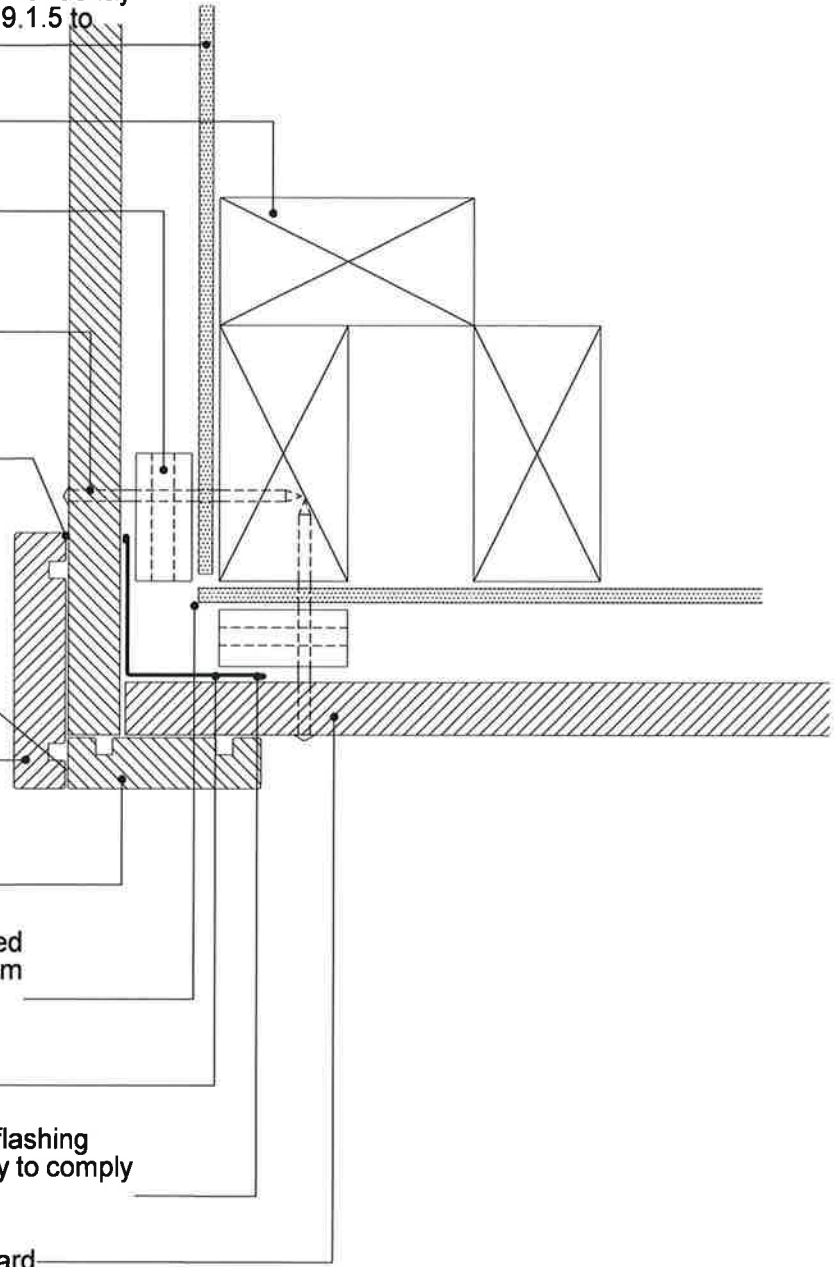

TITLE:				copyright BBS Timbers LTD ©		External corner detail	
	NAME	SIGNATURE	DATE	 27 Kioreroa road PO Box 1407 Whangarei 09 438 9358	DWG NO.	R-RB-05	A4
DRAWN							
CHK'D							
APP'VD							
					SCALE:1:5	DNS	SHEET 1 OF 1