

Notes:

- All nail fixings pre-drilled minimum 1mm diameter smaller than nail gauge
- All products to be pre-coated & cut edges to be sealed as per Branz Bulletin 411
- All materials and fixtures are to comply with E2/AS1 clause 2.2
- Provide PVC tape bond break between H3.2 battens and any flashing
- Vertical Shiplap profiles to be fixed with a minimum 2mm gap at the overlap between boards
- Rigid & Flexible underlay as per Table 23 and Clauses 9.1.5 to 9.1.7 E2/AS1.
- Timber to NZBC B2 Durability b23.1 (b) Western Red Cedar, Larch

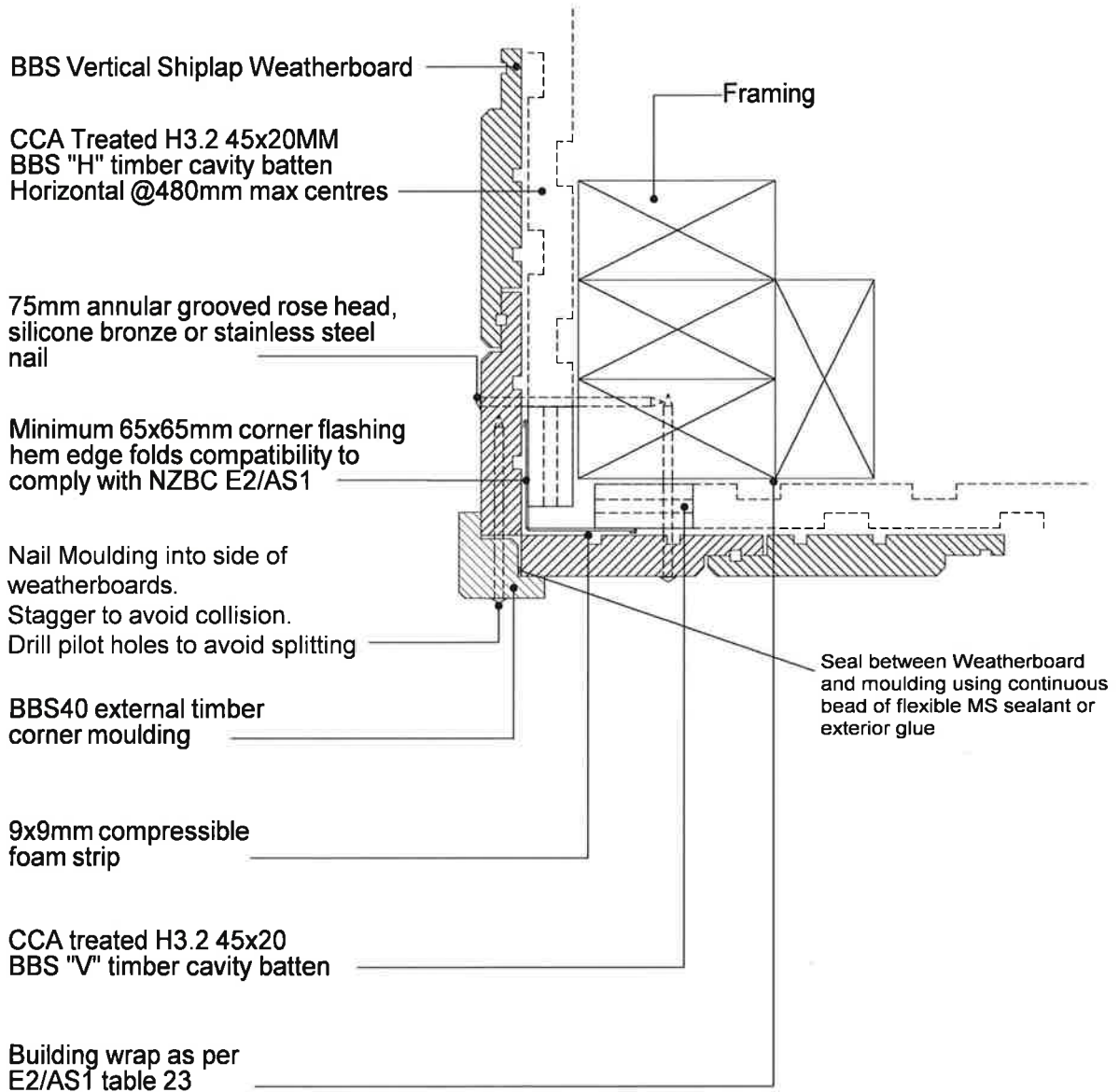

TITLE:				copyright BBS Timbers LTD ©		External corner detail	
	NAME	SIGNATURE	DATE	 27 Kioreroa road PO Box 1407 Whangarei 09 438 9358	DWG NO.	V-CW-03	A4
DRAWN					SCALE: 1:5		
CHK'D							
APPVD							