

Notes:

- All nail fixings pre-drilled minimum 1mm diameter smaller than nail gauge
- All products to be pre-coated & cut edges to be sealed as per Branz Bulletin 411
- All materials and fixtures are to comply with E2/AS1 clause 2.2
- Provide PVC tape bond break between H3.2 battens and any flashing
- Vertical Shiplap profiles to be fixed with a minimum 2mm gap at the overlap between boards
- Rigid & Flexible underlay as per Table 23 and Clauses 9.1.5 to 9.1.7 E2/AS1.
- Timber to NZBC B2 Durability b2.3.1 (b) Western Red Cedar, Larch

A

B

C

D

E

F

Support pipe with a nog under & screw fixed strap over

Flexible flashing tape

Internal wall lining

Framing

CCA treated H3.2 45x20mm BBS "V" timber cavity batten. Vertical @ 480mm max centres

Sealant on backing rod

Vanluk rubber boot with adhesive collar, refer to www.vanluk.co.nz

BBS Vertical Shiplap Weatherboard

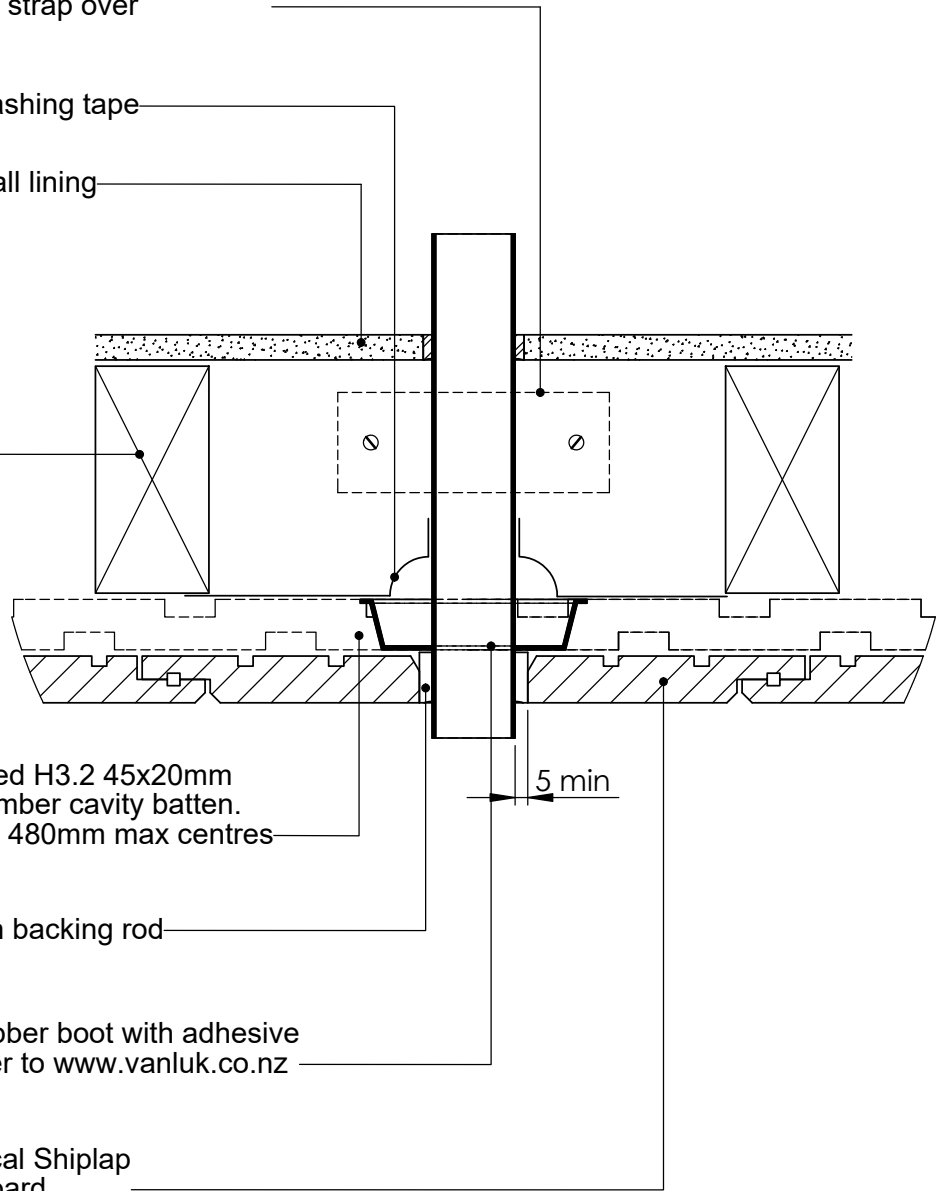

5 min

TITLE:					copyright BBS Timbers LTD ©	Pipe Penetration Detail	
	NAME	SIGNATURE	DATE	Rev	 27 Kioreroa road PO Box 1407 Whangarei 09 438 9358	DWG NO.	A4
DRAWN						V-CW-12	
CHK'D							
APP'VD							
						SCALE:1:20 DNS	SHEET 1 OF 1