

Notes:

- All nail fixings pre-drilled minimum 1mm diameter smaller than nail gauge
- All products to be pre-coated & cut edges to be sealed as per Branz Bulletin 411
- All materials and fixtures are to comply with E2/AS1 clause 2.2
- Provide PVC tape bond break between H3.2 battens and any flashing
- Vertical Shiplap profiles to be fixed with a minimum 2mm gap at the overlap between boards
- Rigid & Flexible underlay as per Table 23 and Clauses 9.1.5 to 9.1.7 E2/AS1.
- Timber to NZBC B2 Durability b2.3.1 (b) Western Red Cedar, Larch

Provide joinery support when appropriate, ensure cavity construction is not compromised

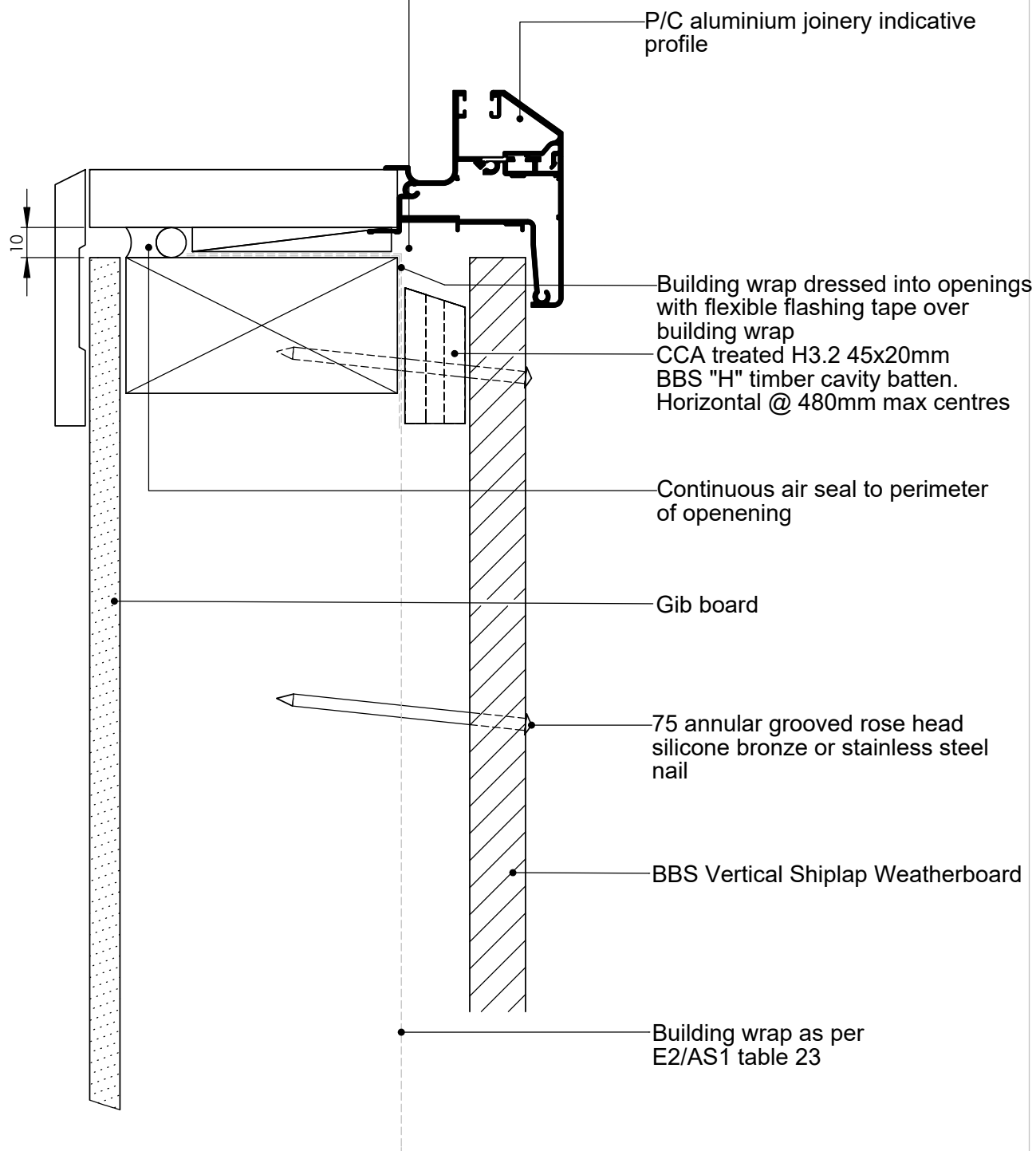

TITLE:

copyright BBS Timbers LTD ©

Aluminium Sill Detail

	NAME	SIGNATURE	DATE	Rev
DRAWN				
CHK'D				
APPV'D				



27 Kioreroa road
PO Box 1407
Whangarei
09 438 9358

DWG NO.

V-CW-23

A4

SCALE:1:10 DNS SHEET 1 OF 1