

Notes:

- All nail fixings pre-drilled minimum 1mm diameter smaller than nail gauge
- All products to be pre-coated & cut edges to be sealed as per Branz Bulletin 411
- All materials and fixtures are to comply with E2/AS1 clause 2.2
- Provide PVC tape bond break between H3.2 battens and any flashing
- Vertical Shiplap profiles to be fixed with a minimum 2mm gap at the overlap between boards
- Rigid & Flexible underlay as per table 23 and clauses 9.1.5 to 9.1.7
- Timber to NZBC B2 durability B23.1 (b), Western Red Cedar, Larch

6mm Fibre cement Rigid Wall Underlay
As per table 23 and clauses 9.1.5 to 9.1.7 and 9.1.7.2 E2/AS1

Framing

CCA treated H3.2 45x20mm
BBS "V" timber cavity batten

CCA treated H3.2 45x20mm
BBS "H" timber cavity batten.
Horizontal @ 480mm max centres

75mm annular grooved
rose head, silicone bronze
or stainless steel nail

Minimum 65x65mm corner
flashing hem edge folds
Compatibility to comply with
NZBC E2/AS1

80mm PBS Butyl tape lapped
evenly to corner over a 100mm
strip PBS Butyl primer

Seal between weatherboards
using continuous bead of
flexible MS sealant or
exterior glue

BBS Vertical Shiplap Weatherboard

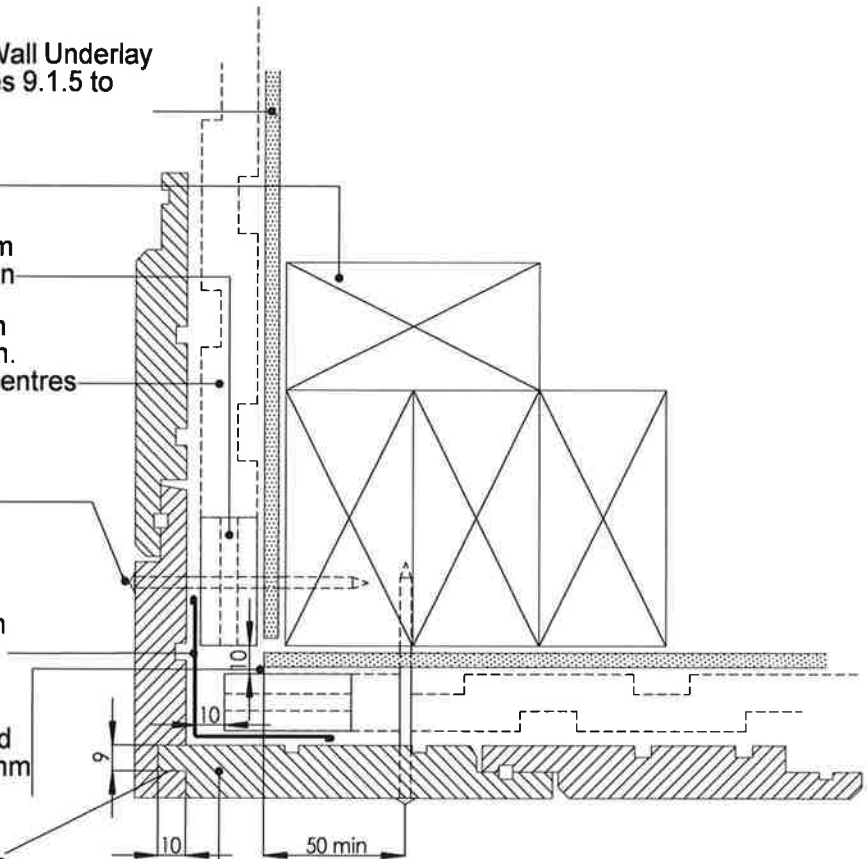

TITLE:				copyright BBS Timbers LTD ©	External corner detail	
	NAME	SIGNATURE	DATE	 27 Kioreroa road PO Box 1407 Whangarei 09 438 9358	DWG NO	A4
DRAWN					VC-RB-20	
CHKD						
APPVD					SCALE:1:5 DNS SHEET 1 OF 1	