

Notes:

- All nail fixings pre-drilled minimum 1mm diameter smaller than nail gauge
- All products to be pre-coated & cut edges to be sealed as per Branz Bulletin 411
- All materials and fixtures are to comply with E2/AS1 clause 2.2
- Provide PVC tape bond break between H3.2 battens and any flashing
- Rigid & Flexible underlay as per table 23 and clauses 9.1.5 to 9.1.7
- Timber to NZBC B2 durability b2.3.1 (b), Western Red Cedar, Larch

Provide joinery support when appropriate, ensure cavity construction is not compromised

Building wrap dressed into openings with flexible flashing tape over building wrap

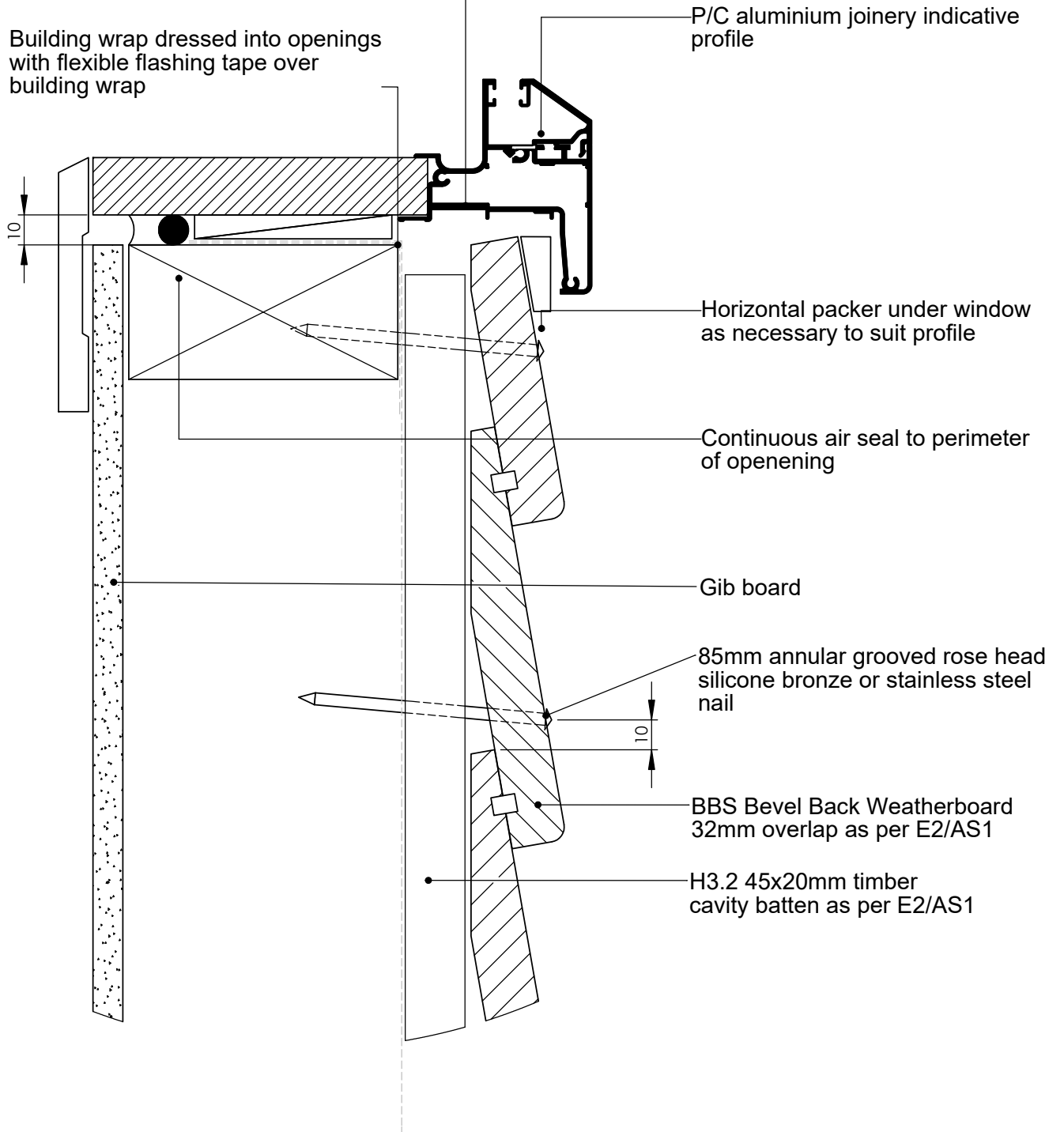

TITLE:					copyright BBS Timbers LTD ©		Aluminium Sill Detail	
	NAME	SIGNATURE	DATE	Rev		DWG NO.	A4	
DRAWN						B-CW-22-S		
CHK'D								
APP'VD								
						27 Kioreroa road PO Box 1407 Whangarei 09 438 9358	SCALE:1:10 DNS	SHEET 1 OF 1